



AOG 1003/3 # 50 017



# OPERATION MANUAL

CONTENTS	Seite
1. Safety Instructions	2
2. General advice	3
3. Technical data	3
4. Description	3
5. Assembling / Installation	3
6. Spare parts and accessories	4
7. Operation	4
8. Maintenance and trouble shooting	4
9. Disposal	4
10. Warranty	4

1.

## 1. Safety instructions



**Please observe:** This operation manual contains all necessary information. Please read carefully to avoid damages and faults. All Rapid pieces of equipment are checked carefully before delivery for their perfect composition and function. In case of improper use all rights to claim under guarantee are void.



Make sure that only skilled staff is working with this device in order to prevent damages and accidents caused by improper use.



Environmental conditions i.e. humidity, low temperatures, sunlight and contamination may damage device.



Before using the device make sure that it is not contaminated to prevent any injury. Avoid any contamination of device as well as of environment. In case of any contamination during operation of device take care that it is immediately and professionally removed.



Always wear safety cloths respecting the applicable regulations for accident prevention



Only use this device conforming to its purpose and function. Improper use can cause severe injuries.



Caution – moving parts, sharp edges, hot machine parts or exhausting steam can cause severe injuries.



Before use always check the device for damages and leaks. In case of any damage or leak make sure that it is repaired professionally before use. Operation of defect device may cause severe injuries.



In case of any sign of damage or malfunction during operation of device stop device immediately to prevent injuries. Before next use make sure that the device professionally repaired.



Take care that in case of an accident all emergency measures are on hand

## 2. General advice

- 6.1 ONLY FOR WASTE OIL OF KNOWN SOURCE FLASH POINT > 55°C FORMERLY DANGEROUS CLASS: AIII (VbF)
- 6.2 Always put up waste oil container secure, prevent unintentional moving.
- 6.3 Always keep the emptying valve closed.
- 6.4 Do not fill in water or petrol, paraffin, kerosene or other easy inflammable liquids.
- 6.5 Always dispose your waste oil at the local collection deposit or your oil dealer.
- 6.6 Before collection of waste oil always check how much waste oil is still in the container.
- 6.7 Do not heat the container above normal inside temperature, keep away from radiant heat or source.
- 6.8 Pressure reducing valve is firmly adjusted and may not be changed.

## 3. Technical data

Container capacity	ca. 80 liter
capacity of collection pan	ca. 10 liter
Pressure in container	max. 0,6 bar
weight	ca. 32 kg
Dimensions	600 x 600 x 1240 mm (L x W x H)
adjusting range of collection pan	1140 - 1820 mm

## 4. Description

## 5. Assembling / Installation

- 5.1. Screw collection pan pos. 2 on the filling pipe pos. 4 and seal with Teflon tape.
- 5.2. Put the funnel sieve top pos. 1 on to the collection pan pos.2.
- 5.3. Plug in steering bow pos. 7 in sleeves on the container and fix it with screws.  
See picture 1.
- 5.4. Close emptying valve pos. 12
- 5.5. Remove female adapter Pos. 17 from the male adapter Pos. 13 and screw into the inlet of the collection tank
- 5.6. Hang in outlet bend of the emptying hose in the holder. Pos. 15
- 5.7. Assembling of wheels see Pict. 2  
- Insert in the rollers Pos. 9 into the roll holders

- Put the retaining washers over the threaded bolt of the rollers
- Screw the nuts onto the threaded bolts and tighten it carefully
- Insert the castors Pos. 10 to the axle
- Secure the castors by screwing in the shouldered screw into the threaded hole of the axle.

5.8. Before first use the o-rings of the male adapter Pos. 13 have to be



Abb.1



Abb.2

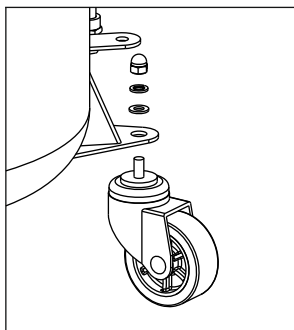

Abb.3

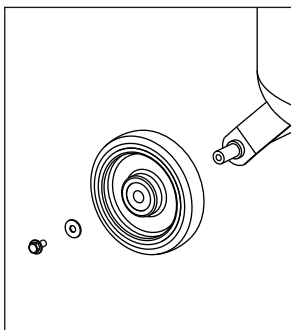

3x Nr. 1

1

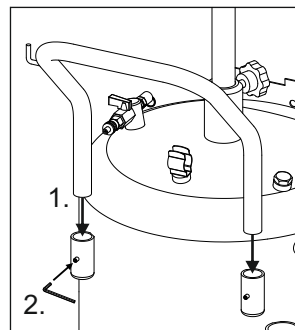
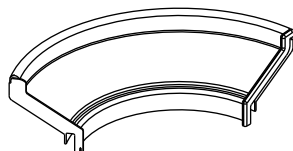
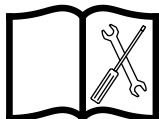
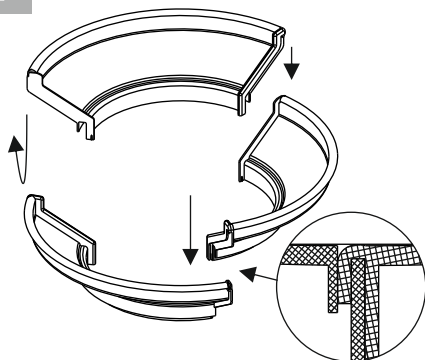

2

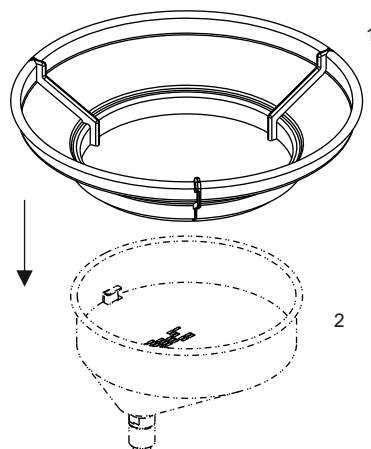

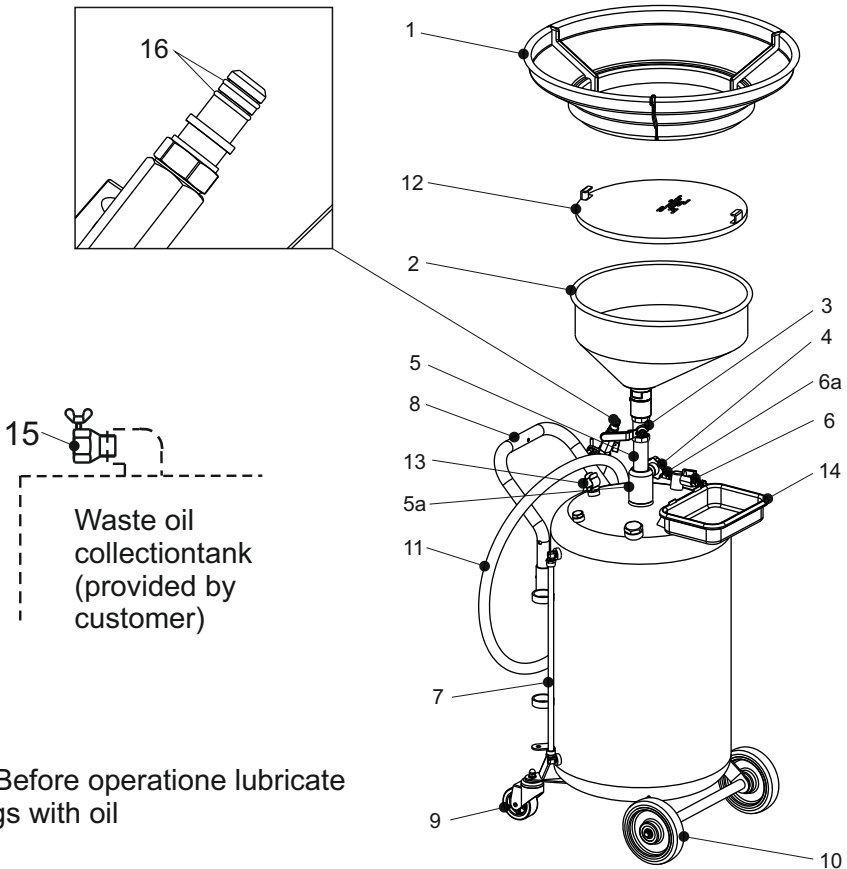

\* Before operations lubricate  
O-rings with oil

Pos.	Designation	Art.No.
1	Funnel sieve top TAS	50 520
2	Collection pan AOT	50 500
3	KGH 25	20 562
4	Clamping screw	50 513
5	Filler pipe	50 514
5a	Gasket kit DS EFR	50 523
6	Compressed air connection	50 524
6a	Pressure relieve valve	50 525
7	Level indicator FA	50 518

Pos.	Designation	Art.No.
8	Steering bow	50 526
9	Steering wheel ÖLR/3	50 529
10	Wheel KRG/3	50 528
11	Suction-emptying hose SAS	51 520
12	Collection pan sieve	50 519
13	Hose clamp	50 527
14	Storage tray KTS	50 521
15	female adapter AGA	51 517
16	Gasket kit DS DCA	51 527

## 7. Operation

### 7.1 Waste oil collection:

- 7.1.1. Before start working always check with level indicator pos. 7 how much waste oil is within the container. In case the container is too full, please empty first as explained in chapter
- 7.1.2. Place the unit below the oil drain outlet. Push up the collection pan as far as possible and secure with clamping screws.
- 7.1.3. Open the filler valve Pos.3, and air inlet valve at Pos. 6, by unscrewing them until the venting slots are unblocked.
- 7.1.4. Now waste oil flow in.

### 7.2 Emptying of the container

- 7.2.1. Place the unit besides the waste oil collection tank. Push down the collection pan as far as possible and secure with clamping screws.
- 7.2.2. CAUTION! It is indispensable to close the filler valve Pos. 3, and air inlet valve at Pos. 6..
- 7.2.3. Insert male adapter (with hose Pos. 11) into the female adapter Pos: 15 and fix it.
- 7.2.4. Open emptying valve (with hose pos.11).
- 7.2.5. Establish a compressed air connection to Pos. 6 by using a tyre inflator. Fill the container with 0,5 bar. Container will be cleaned out
- 7.2.6. After the container is empty disconnect the compressed air and let the pressure within the container completely leaking out of the container.
- 7.2.7. Close drain valve (with hose Pos. 11)
- 7.2.8. Clamp in hose Pos. 11 to the holder Pos. 13

## 8. Maintenance and trouble shooting

- 8.1 Before every use all parts of the unit which are getting in contact with the medium have to be checked carefully if there are leaks or and if so eliminate.
- 8.2 In case of spilled waste oil pick it up with suitable means and properly. No waste oil may pollute soil or sewerage system.
- 8.3 If necessary, inside of container can be cleaned by filling in an emptying Diesel.

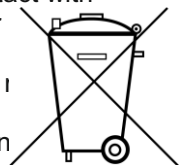

## 9. Disposal

- 9.1 Completely empty all parts of the equipment ( hoses, pumps , tanks , etc ) and given case blown out with air .
- 9.2 dangerous parts of the appliance must be made unusable f.e. perforate

## YOUR CONTRIBUTION TO PROTECT THE ENVIRONMENT

The pertinent regulations for the registration, setting up and operation of equipment for dealing with materials hazardous to water must always be complied with by the user.

### 10. Warranty

10.1 In case of insufficient maintenance, faults on operation, use of not adequate

spare parts or attachments all liabilities and rights of claim under guarantee

are void.

10.2 The manufacturer is not liable for improper use of the container or ignoring the safety instructions.

10.3 Technical modifications are subject to change without announcement.

