



GTK 60/6-P
GTK 60/200/6-P
GTK 200/3-P

22 310
22 311
22 312



OPERATION MANUAL

CONTENTS	Seite
1. Safety Instructions	2
2. General advice	3
3. Technical data	3
4. Description	3
5. Assembling / Installation	4-8
6. Spare parts and accessories	9
7. Operation	10
8. Maintenance and trouble shooting	10
9. Disposal	11
10. Warranty	11

1.

1. Safety instructions



Please observe: This operation manual contains all necessary information. Please read carefully to avoid damages and faults. All Rapid pieces of equipment are checked carefully before delivery for their perfect composition and function. In case of improper use all rights to claim under guarantee are void.



Make sure that only skilled staff is working with this device in order to prevent damages and accidents caused by improper use.



Environmental conditions i.e. humidity, low temperatures, sunlight and contamination may damage device.



Before using the device make sure that it is not contaminated to prevent any injury. Avoid any contamination of device as well as of environment. In case of any contamination during operation of device take care that it is immediately and professionally removed.



Always wear safety cloths respecting the applicable regulations for accident prevention



Only use this device conforming to its purpose and function. Improper use can cause severe injuries.



Caution – moving parts, sharp edges, hot machine parts or exhausting steam can cause severe injuries.



Before use always check the device for damages and leaks. In case of any damage or leak make sure that it is repaired professionally before use. Operation of defect device may cause severe injuries.



In case of any sign of damage or malfunction during operation of device stop device immediately to prevent injuries. Before next use make sure that the device professionally repaired.



Take care that in case of an accident all emergency measures are on hand

2. General advice

Pay attention to a safe stand when setting up the GTK device.

Remove any spilled medium immediately and dispose it according to local regulations.

Setting up the device within explosion hazard areas is not permitted!

The GTK device is not suitable for setting up outside. Choose a dry and cool area.

Skilled staff may only carry out work on GTK device.

3. Technical data

	GTK
Dimensions	1940x860x1814-1904
Weight	ca. 202kg
	Drain pan
Carrying capacity	800kg
Volume	230 Ltr.
	Pump
Air pressure inlet	5-8 bar
Air connection	G 1/4" iG
Connections	G 1/2" aG / 1" iG
Weight	4,5kg
Air consumption	240 l/min
Delivery rate max.	18 l/min
Delivery pressure	24 bar
Noise level	ca. 82 dB

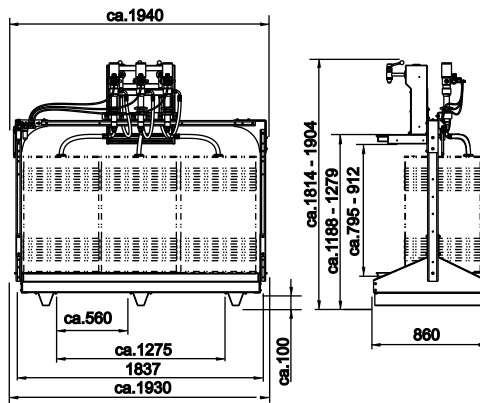

4. Description

The GTK device consists of an equipment rack with drain pan, oil bar and three pumps designed for a comfortable oil supply.

5. Assembling / Installation

 <p>2x A1 1x A2</p>	 <p>1x E2</p>	 <p># 22 310 # 22 312 # 22 311 DIN 933 M 8x20 58x 48x H</p>
 <p>3x A3</p>	 <p>1x E3</p>	 <p>DIN 603 M 8x55 2x I</p>
 <p>1x A4 1x A5</p>	 <p># 22 310 # 22 312 # 22 311 1x E4</p>	 <p>DIN 933 M 8x100 4x J</p>
 <p>2x A6</p>	 <p>1x E5</p>	 <p># 22 310 # 22 312 # 22 311 DIN 7991 M 8x20 8x 4x K</p>
 <p>2x A7</p>	 <p># 22 310 # 22 312 # 22 311 6x 3x F1</p>	 <p>DIN 933 M 8x16 2x L</p>
 <p>1x B</p>	 <p># 22 310 # 22 312 # 22 311 6x 3x F2</p>	 <p># 22 310 # 22 312 # 22 311 DIN 603 M 8x20 8x 4x M</p>
 <p># 22 310 # 22 312 # 22 311 2x 1x C1</p>	 <p># 22 310 # 22 312 # 22 311 6x 3x F3</p>	 <p># 22 310 # 22 312 # 22 311 DIN 125 A 8,4 88x 64x N</p>
 <p># 22 310 # 22 312 # 22 311 4x 2x C2</p>	 <p># 22 310 # 22 312 # 22 311 6x 3x F4</p>	 <p># 22 310 # 22 312 # 22 311 DIN 6797 J 8,4 82x 64x O</p>
 <p># 22 310 # 22 312 # 22 311 2x 1x D1</p>	 <p># 22 310 # 22 312 # 22 311 6,5m 3,5m G1</p>	 <p># 22 310 # 22 312 # 22 311 DIN 934 M 8 82x 64x P</p>
 <p># 22 310 # 22 312 # 22 311 6x 3x D2</p>	 <p># 22 310 # 22 312 # 22 311 6x 3x G2 1,3m</p>	 <p>DIN 7991 M 6x16 2x Q</p>
 <p>1x E1</p>	 <p># 22 310 # 22 312 # 22 311 6x 3x G3 0,9m</p>	 <p>DIN 1587 M 6 2x R</p>

1

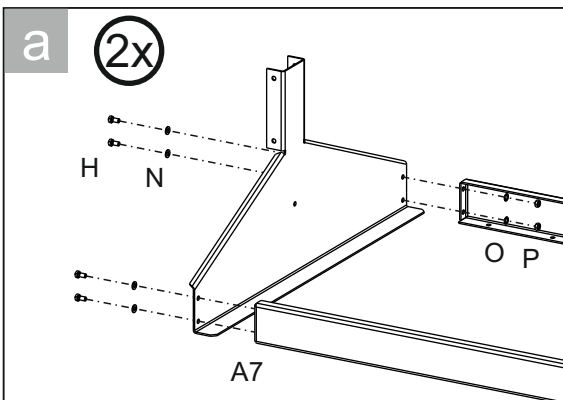
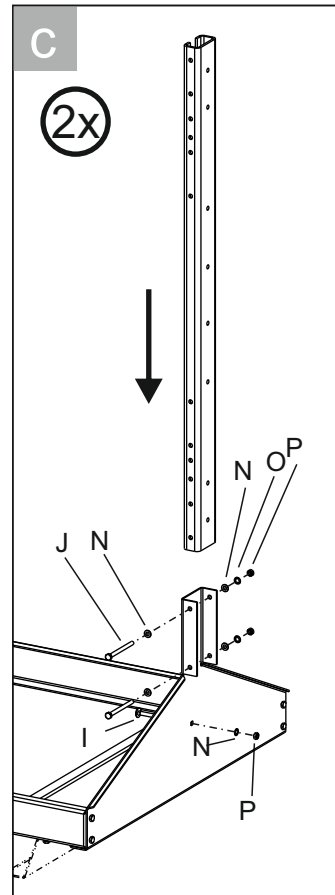
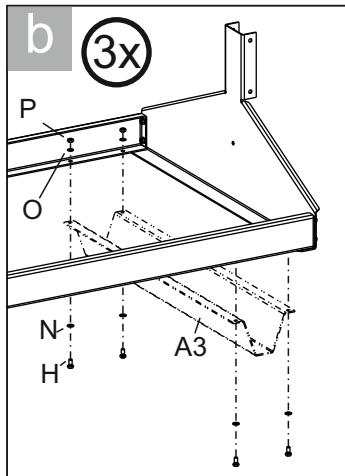
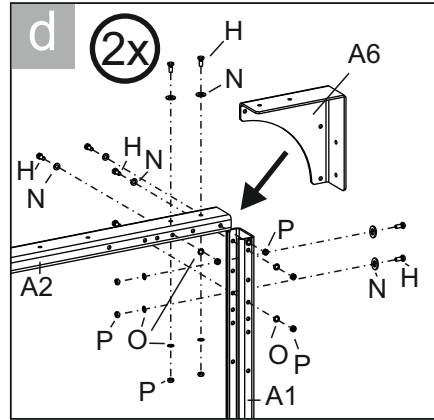
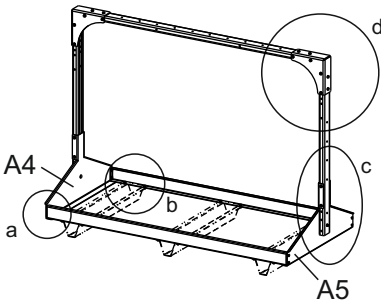

2

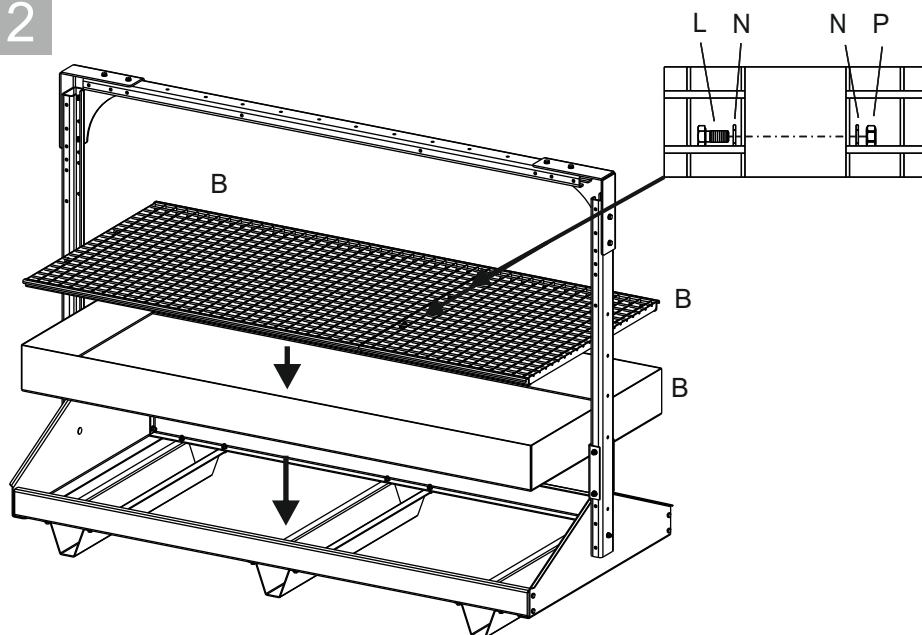

3

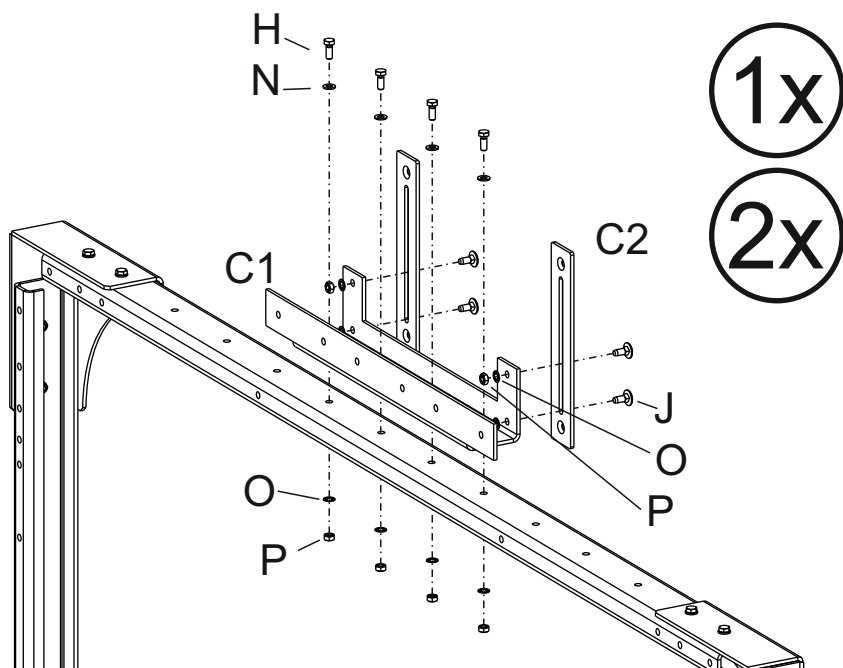

4

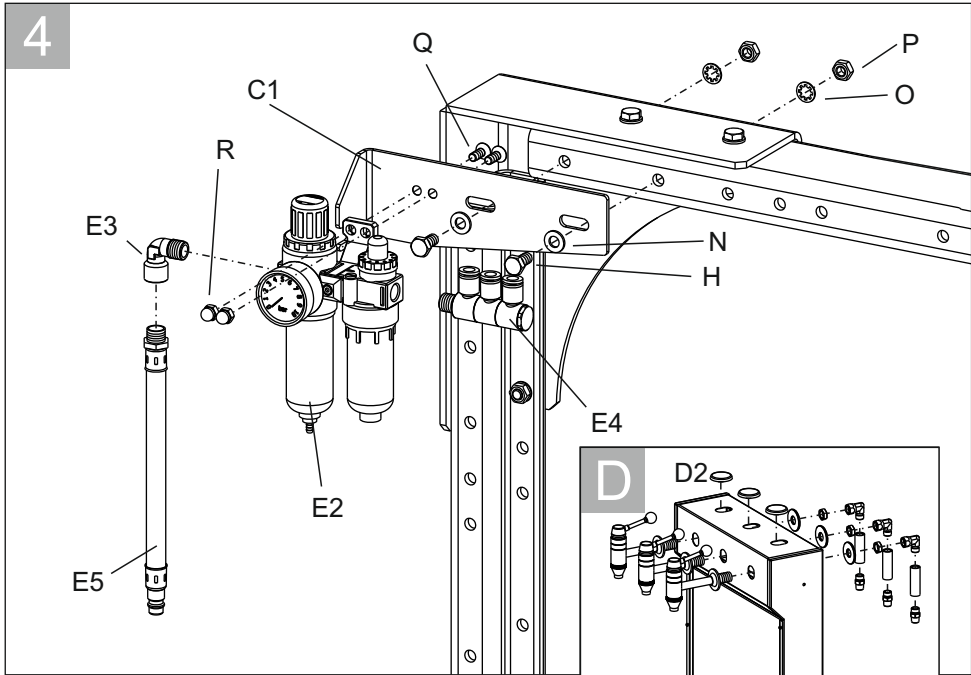

5

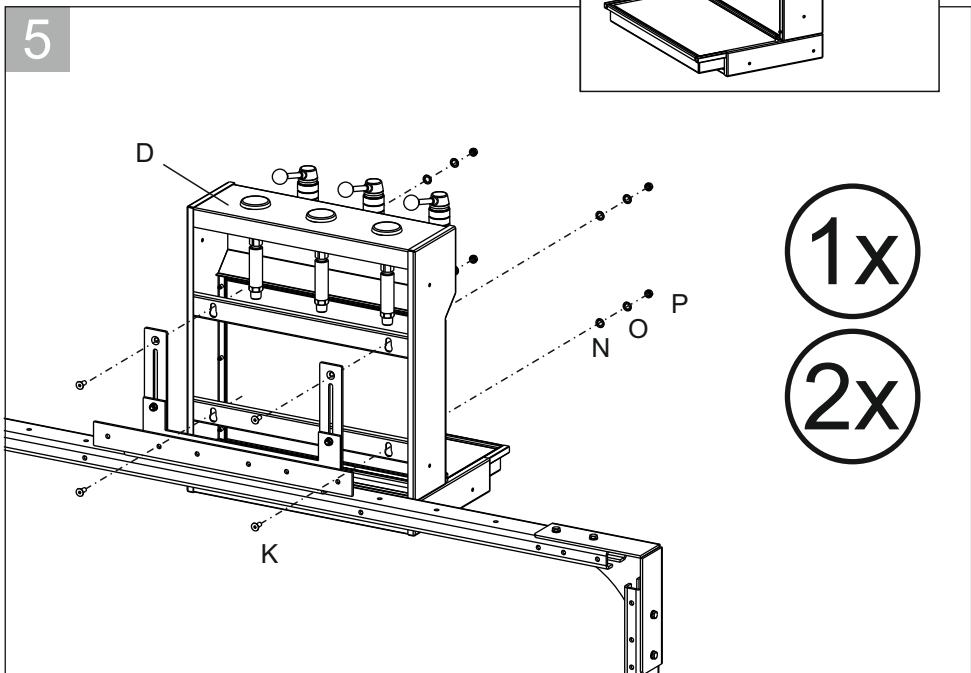

6

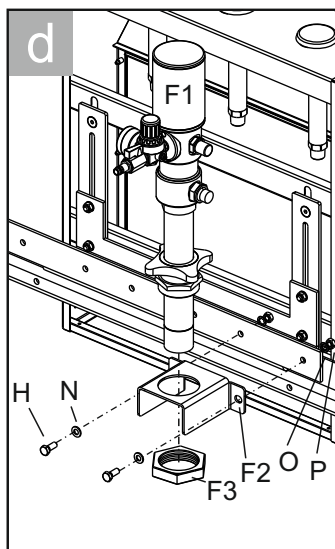

3x

6x

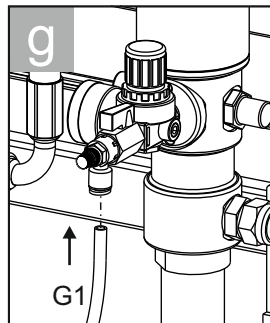
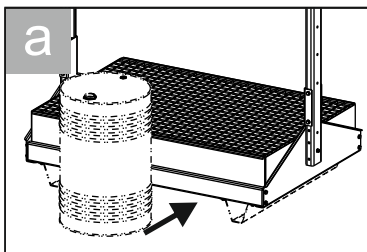
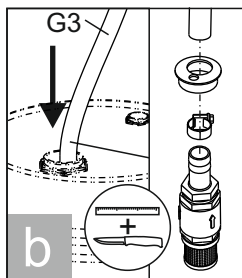
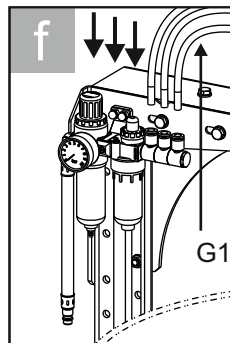
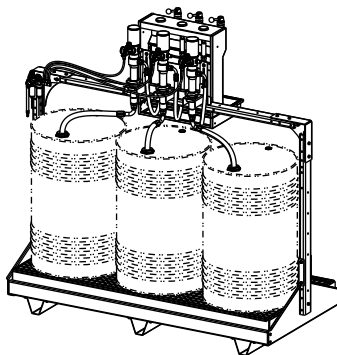
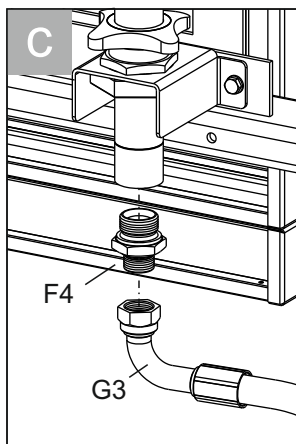
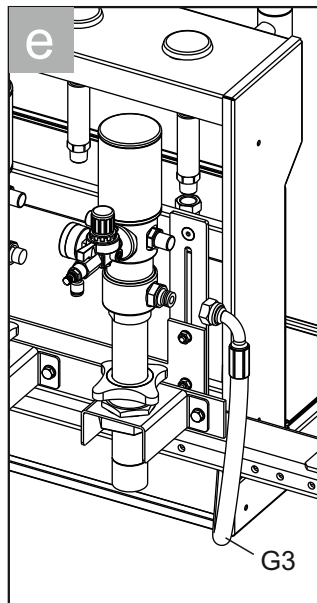

6. Spare parts and accessories

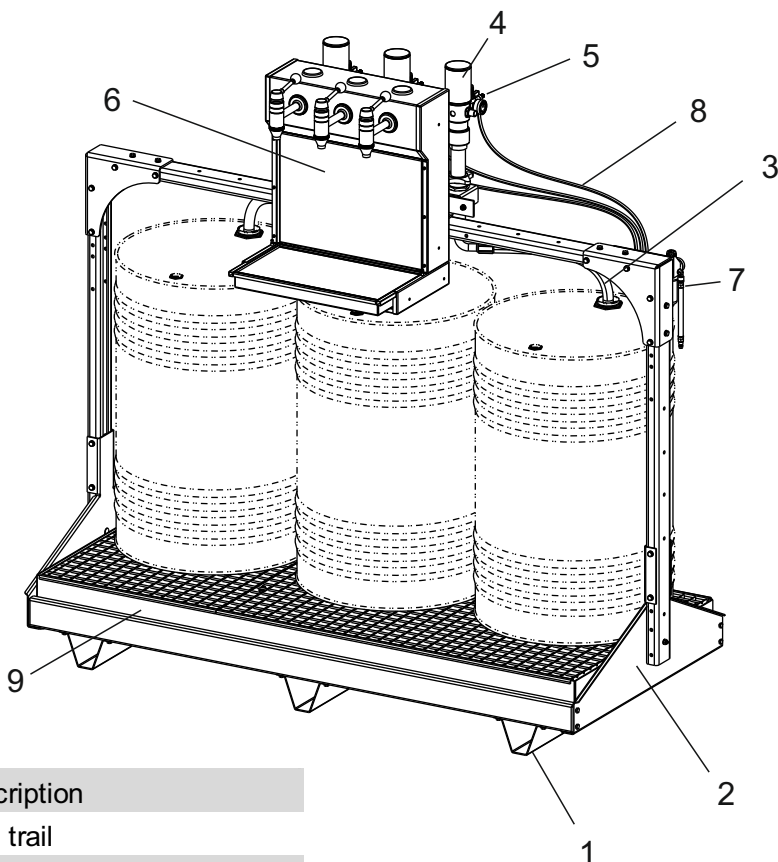

Pos.	Description
1	Foot trail
2	Rack
3	Suction hose
4	Pump
5	Pressure reducer
6	Oilbar
7	Air maintenance unit
8	Air hose
9	Collection pan

7. Operation

Skilled staff may only carry out all work.

Impurities have to be removed immediately according to local regulations.

Before operating the GTK device check it for leaks and defects and if necessary repair.

In times out of work the system must be depressurized to prevent damages and accidents.

7.1 Connect to air supply. Open the ball cock of compressed of pneum. maintenance unit. The pumps start operating.

7.2 Put the bin which shall be filled under the spigot chosen of oil bar

7.3 Operate the tap to get out the oil

7.4 Once the desired amount is reached, return the tap to its original position to complete the tapping process

7.5 Close the ball cock of pneum. maintenance unit and cut off the air supply.

8. Maintenance and trouble shooting

Check the device from time to time for leaks, damages and impurities and if necessary remove and repair, in order to prevent damages and accidents.

Skilled staff may only carry out repairs.

Problem	Reason	Solution
Pump does not run	No air supply	Connect to air supply
	Flexible air hose defect	Replace hose
	Ball cock closed at air supply	Open ball cock
	Pump is clogged	Clean the pump
	Pump is defect	Contact manufacturer
Pump does not supply	Suction hose clogged	Clean suction hose
	Pressure reducer defect	Replace pressure reducer
	Pump does draw air	Check for leaks and if necessary repair
Oilbar does supply no or only little oil	Pump does not run	Check pump - refer to above mentioned
	Spigot jammed	Repair spigot
	Spigot clogged	Clean spigot
	Barrel is empty	Replace barrel
Oil bar draws air	Suction hose not deep enough inserted	Put suction hose deeply into the medium
	Suction hose defect	Repair suction hose
	Connections are leaking	Seal in again the connections

9. Disposal

- 9.1 Completely empty all parts of the equipment (hoses, pumps , tanks , etc) and given case blown out with air .
- 9.2 Dangerous parts of the appliance must be made unusable f.e. perforate pressure vessel , deform hose reels , etc.
- 9.3 Rubber , metals, glass ect. must be separated. Dispose material fractions according to the local laws and regulations .

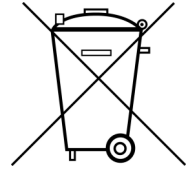

YOUR CONTRIBUTION TO PROTECT THE ENVIRONMENT

The pertinent regulations for the registration, setting up and operation of equipment for dealing with materials hazardous to water must always be complied with by the user.

10. Warranty

- 10.1 In case of insufficient maintenance, faults on operation, use of not adequate spare parts or attachments all liabilities and rights of claim under guarantee are void.
- 10.2 The manufacturer is not liable for improper use of the container or ignoring the safety instructions.
- 10.3 Technical modifications are subject to change without announcement.

