



OP 90 D 35/1
OP 90 D 30/1
OP 90 D 25/1

20 001
20 002
20 003



OP90D 35/1



OP90D 30/1



OP90D 25/1

OPERATION MANUAL

CONTENTS	Seite
1. Safety Instructions	2
2. General advice	3
3. Technical data	3
4. Description	4
5. Assembling / Installation	4
6. Spare parts and accessories	4
7. Operation	5
8. Maintenance and trouble shooting	5
9. Disposal	5
10. Warranty	5

1. Safety instructions



Please observe: This operation manual contains all necessary information. Please read carefully to avoid damages and faults. All Rapid pieces of equipment are checked carefully before delivery for their perfect composition and function. In case of improper use all rights to claim under guarantee are void.



Make sure that only skilled staff is working with this device in order to prevent damages and accidents caused by improper use.



Environmental conditions i.e. humidity, low temperatures, sunlight and contamination may damage device.



Before using the device make sure that it is not contaminated to prevent any injury. Avoid any contamination of device as well as of environment. In case of any contamination during operation of device take care that it is immediately and professionally removed.



Always wear safety cloths respecting the applicable regulations for accident prevention



Only use this device conforming to its purpose and function. Improper use can cause severe injuries.



Caution – moving parts, sharp edges, hot machine parts or exhausting steam can cause severe injuries.



Before use always check the device for damages and leaks. In case of any damage or leak make sure that it is repaired professionally before use. Operation of defect device may cause severe injuries.



In case of any sign of damage or malfunction during operation of device stop device immediately to prevent injuries. Before next use make sure that the device professionally repaired.



Take care that in case of an accident all emergency measures are on hand

2. General advice

- 2.1 During working pauses and shutdowns the air stopcock in front of the pump must be closed, to avoid unintentional supply, for example in case of a leak within the pipe or in case of a leaking hose.
- 2.2 Only special companies licensed according German Law § 19 I WHG (water management act) are allowed to work on oil installations.
- 2.3 In case of permanent installed oil pipe lines a relief valve as a security valve must be built in at the pump. Its reverse hose must lead into the oil storage container.
- 2.4 Do not operate within areas of danger of explosion or near open fire.
- 2.5 Not suitable for inflammable mediums R10, R11, R12 (regulation regarding dangerous mediums) resp. dangerous class A1, A2, B (VbF).

3. Technical data

OP90D-	-35/1 (K) (E)	-30/1 (K) (E)	-200/1 (K) (E)
Ratio:	1:1	3:1	5:1
Max. discharge pressure with 8 bar compr. air conn. (bar):	8	24	40
Discharge capacity max. with unblocked discharge (ca. l/min)	18	18	18
Oil inlet:	G 3/4"	G 3/4"	G 3/4"
Oil outlet:	G 1/2" e.thr.	G 1/2" e.thr.	G 1/2" e.thr.
Max. Air consumption with 8 bar comp. air conn. (l/min):	240	240	240
Air pressure min./max. (bar):	5-8	5-8	5-8
noise level (ca. dB):	82	82	82
Thread air connection:	G 1/4" i.thr.	G 1/4" i.thr.	G 1/4" i.thr.

Picture 1

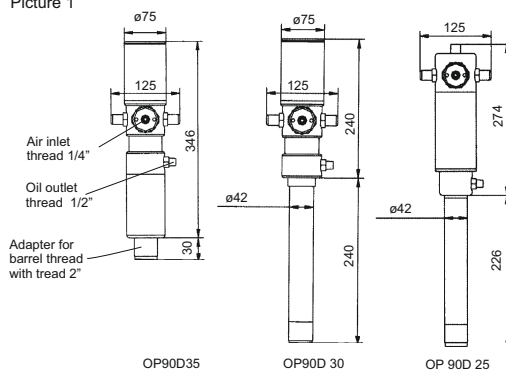

Performance chart (SAE about 20°C, air supply 8 bar)
Leistungsdiagramm: (SAE 20 ca.20°C, Luftanschlußdruck 8 bar)

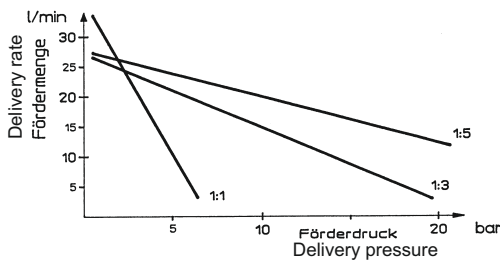

4. Description

Type	Ref.-no.	Type	Ref.-no.	Type	Ref.-no.
OP90D 35/1	20 001	OP90D 30/1	20 002	OP90D 25/1	20 003
OP90D 35/1 K	20 004	OP90D 30/1 K	20 005	OP90D 25/1 K	20 006
OP90D 35/1 E	20 007	OP90D 30/1 E	20 008	OP90D 25/1 E	20 009
OP90D 35/1 K/E	20 010	OP90D 30/1 K/E	20 011	OP90D 25/1 K/E	20 012

- 4.1 /1 = oil pump with rigid suction pipe for mounting on the barrel.
 4.2 /1 "K" = stubby pump with flexible suction tube for mounting on the wall above barrel or tank by means of an additional bracket.
 4.3 /1 "E" = calibratable version with air separator according

5. Assembling / Installation

- Unwrap the pump and remove all protection caps. Seal the suction pipe at the thread by means of a Teflon stripe. For the "K" version of pump seal the thread at pump side by means of a Teflon stripe.
- Insert the suction pipe of the pump into the big bung hole of the barrel and fix it with the adapter for the barrel thread. For the stubby pump version mount the bracket at a suitable place above the storage container and fix the pump to the bracket. Screw the suction tube to the suction orifice and insert it into the storage container.
- Screw the oil delivery hose to the outlet connection. In case of connecting to a pipe line use flexible hose model ÖSV 01.12 or ÖSV 01.20.
- When connecting to a pipe line a relief valve model ÜSV 16 must be built in. Reflux hose has to be insert to the storage container.
- Set up a flexible air connection with the possibility to block. It is indispensable to use a maintenance unit with filter, oiler and pressure reducer. Supply regularly oil and remove water out of the filter. Adjust the operating air pressure between 5 bar and 8 bar max.

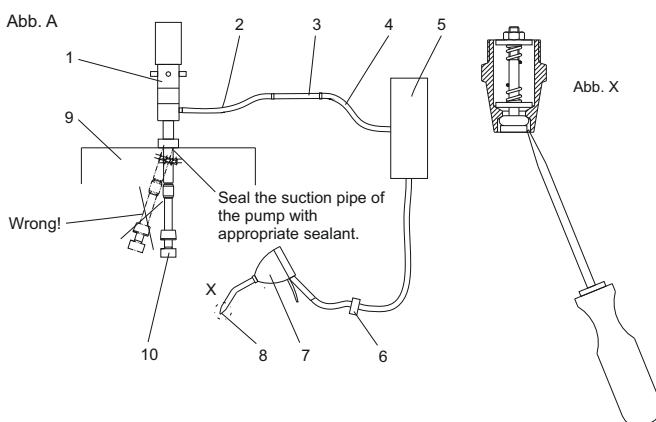

6. Spare parts and accessories

Pos.	Description	Pos.	Description	Pos.	Description
1	Pumpe	6	Hose stop	11	Ball valve
2	Connecting tube for oil	7	Fuel nozzle	12	Pressure reducer
3	Pipeline	8	Anti-drip nozzle	13	Plug for air coupling
4	Connecting tube for oil	9	Barrel / Tank		
5	Hose reel	10	Prevention für air inlet (only for calibratable version) Always install upright		

7. Operation

Before the first placing into operation, after change of barrels or after long term shut-downs the systems must be completely ventilated. (see operation manual point 4).

Mostly oil guns and meters are fitted with outlet pipe and anti-drip nozzle, it is recommended to lift the anti-drip nozzle by means of a screw-driver (see picture X) and operate gun or meter. As soon as oil-air mixture leaks from, the anti-drip nozzle can be released again. After this the final ventilation is carried out automatically. As soon as no further air pockets are seen the delivery gun can be closed. The system is now ready for use.

- 7.1 Open the blocking valve of the air line.
- 7.2 Open the oil pistol or oil meter, now pump starts to work and supplies oil.
- 7.3 Close the oil pistol or oil meter, now pump stops working
- 7.4 Do not operate pump within an area of possible danger of explosion or near open fire.
- 7.5 Pump only for fresh oil, waste oil, anti freeze dangerous class AIII(VbF), hardly inflammable.

8. Maintenance and trouble shooting

- 8.1 Before every use all parts of the unit which are getting in contact with the medium i.e. pump, hoses and oil pistol as well as the compressed air supplying hoses have to be checked carefully if there are leaks or damages and if so eliminate.
- 8.2 Always refill the compressed air maintenance unit with suitable oil.
- 8.3 In case of spilled waste oil pick it up with suitable means and remove it properly. No waste oil may pollute soil or sewerage system.

Problem	Cause	Solution
Pump does not draw in	Dust trap within suction line clogged	Clean dust trap
	Suction hose or pipe is too long	Shorten it
	Air within suction line	Ventilate suction line and pump
Delivery capacity is too low	Dust trap within suction line clogged	Clean dust trap
	Oil temperature less than 18°C	Warm up oil
Air within the supplying line	Suction line is leaking	Seal leakage
	Reflux hose is bended or blocked	Repair it
Pump is working, but does not supply	Barrel or tank is empty	Change or refill

9. Disposal

- 9.1 Completely empty all parts of the equipment (hoses, pumps , tanks , etc) and given case blown out with air .
- 9.2 Dangerous parts of the appliance must be made unusable f.e. perforate pressure vessel , deform hose reels , etc.
- 9.3 Rubber , metals, glass ect. must be separated .
Dispose material fractions according to the local laws and regulations .

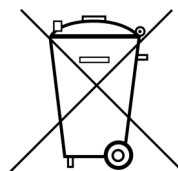

YOUR CONTRIBUTION TO PROTECT THE ENVIRONMENT

The pertinent regulations for the registration, setting up and operation of equipment for dealing with materials hazardous to water must always be complied with by the user.

10. Warranty

- 10.1 In case of insufficient maintenance, faults on operation, use of not adequate spare parts or attachments all liabilities and rights of claim under guarantee are void.
- 10.2 The manufacturer is not liable for improper use of the container or ignoring the safety instructions.
- 10.3 Technical modifications are subject to change without announcement.

